

PROFILE HEAD K82

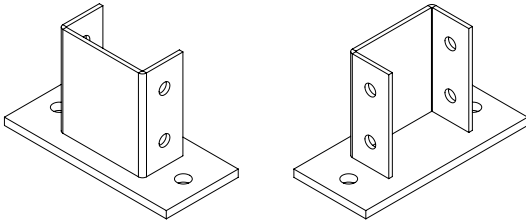

Coating: HDG

Characteristics:

- Metallic
- Non-flame propagating component
- Electrically conductive component
- With metallic coating. Resistance to corrosion:
HDG: class 6

INSTRUCTIONS FOR USE

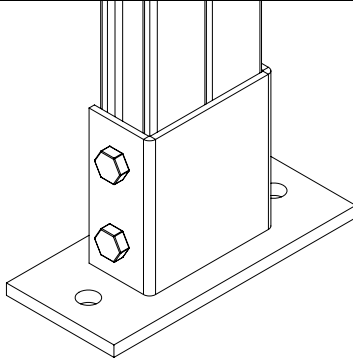

- profile head K82 is used to fix 82x41 double strut profiles to wall, floor or ceiling.
- To fix K82 to wall / ceiling / floor, two anchors SCM 12x85 are needed.
- To fix 82x41 double strut profile to K82, four spring nuts M10 and four bolts M10x30 DIN 933 are needed.
- K82 is usually used with products of BASORPERFIL 41/82 family to make up rack supports, specila tunnel supports, or even solar energy structures.

WORKING LOAD

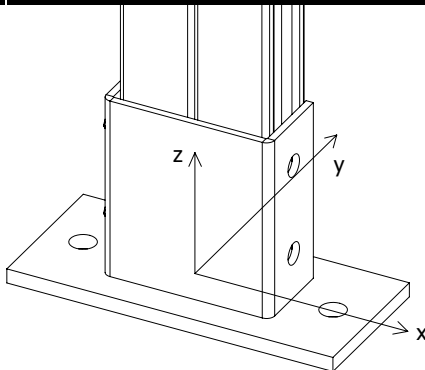

ADMISSIBLE EFFORTS

K82	My	Fx	Fz
	kg.m	kg	kg
	200	1900	2000

Declared values include 1.7 safety factor as requested in EN IEC 61537 for cable tray supports.

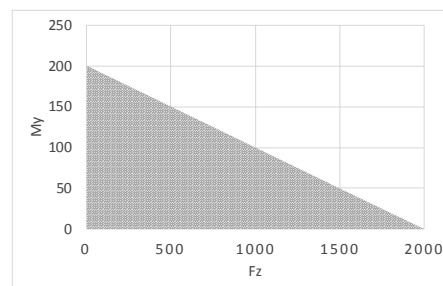

In order to check the part in a concrete application as a down / ceiling element, it will be verified that the simultaneous stresses due to the moment and the load are within the safe area of the graph.

NOTE: In the case of roof downslope, the load value will be limited to the slip value of the spring nut by the number of nuts (4x350 = 1400kg).

Related products:

BASORPERFIL 41/82 profiles and accessories.